

SURVEYOR'S RECORD

Section 10

Township 105

Range 42

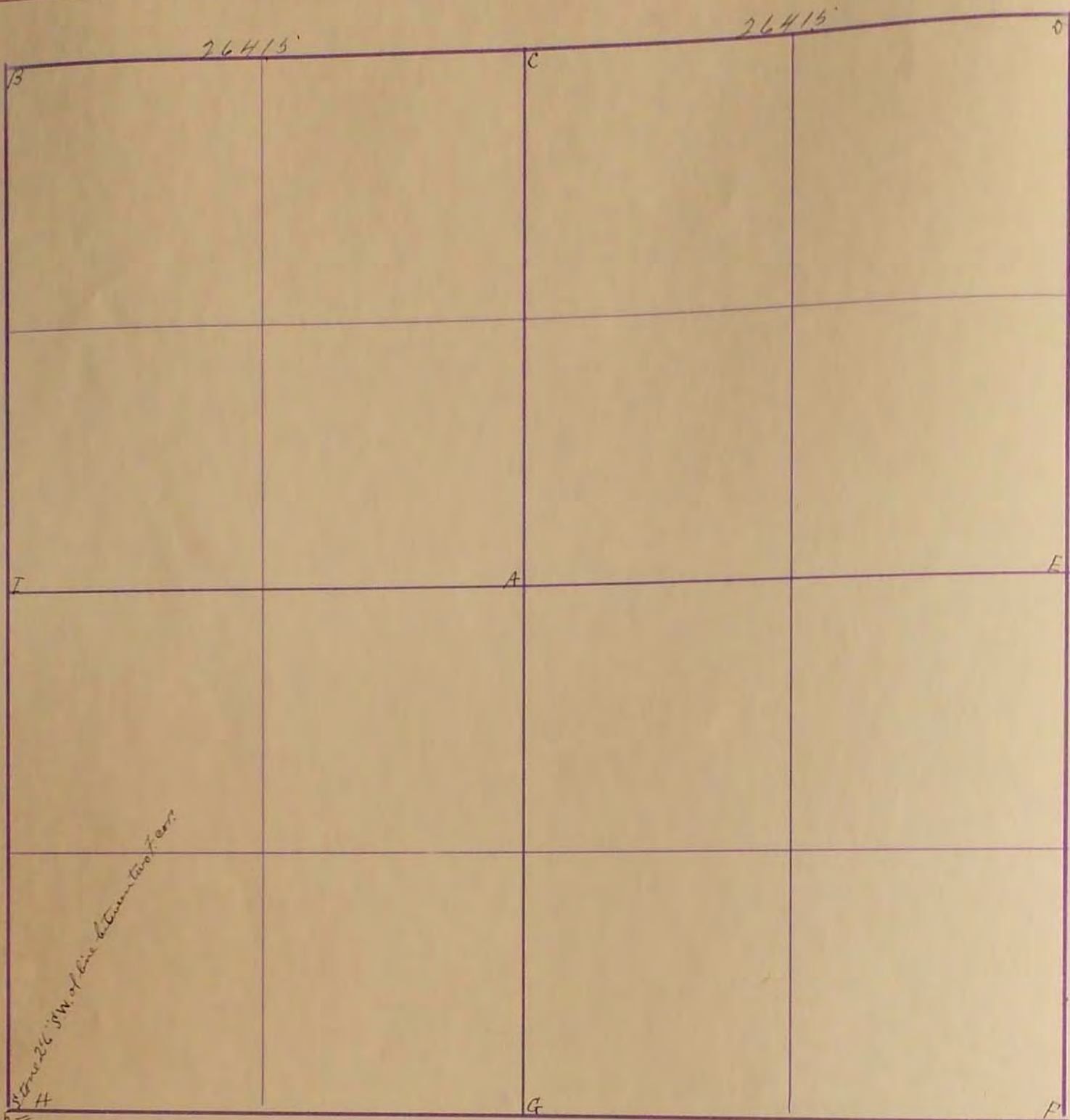

10
11

FP475
TP422 #15 PC
Sept 24 1930
H Found old stone. Placed two pieces of concrete
on top and stone on top of concrete 10x17x20.
April 1921 At Spind above
"D" Cons. Cylinder marked with "K" N40 in T.C.T. NW 59.13'
N40 in FR. N. 50.28'

"E" Placed 1/2" R.B. above hub. - N40 brace Post at Gate S.W. 60.22 N40 Brace Post W. 51.35. N40 P.P. S.E. 50.58

SURVEY No. _____

Section 10

Town 105

Range 42



T.P.

425 425 F90

T.P.

Sept. 24-1930

FIELD NOTES.

H. Found old stone, placed two pieces of concrete on top and stone on top of concrete. 10x12x20.